

NARROW PIZZA PREP TABLE

PREP TABLE



FTTB-900



FTTB-1500



FTTB-1200



FTTB-1800

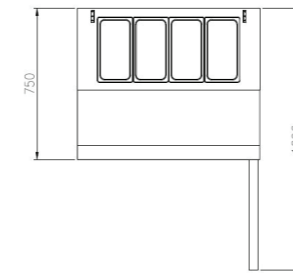

FTT-900

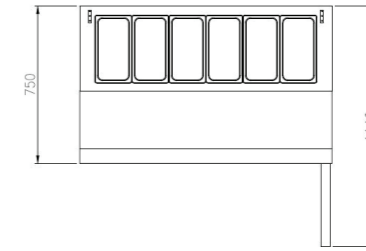

FTT-1200

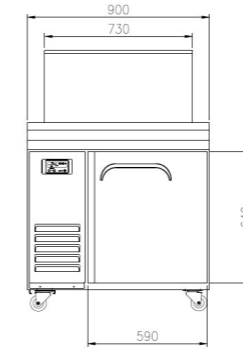

FTT-900

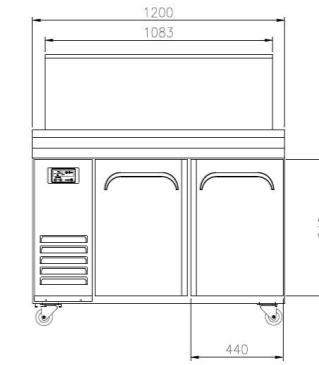

FTT-1200

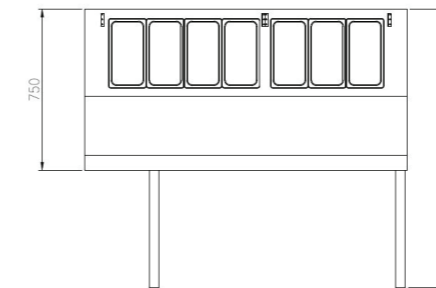
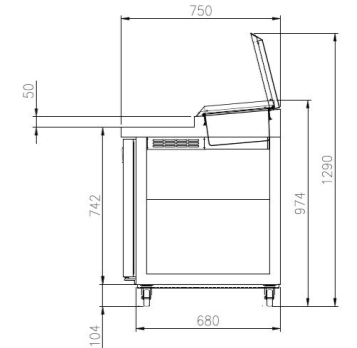

FTT-1500

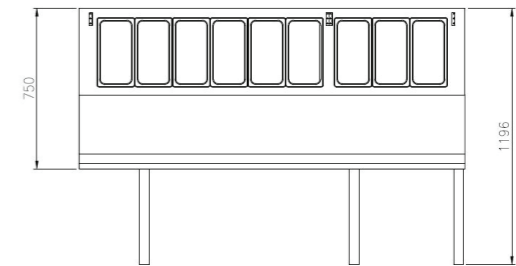

FTT-1800

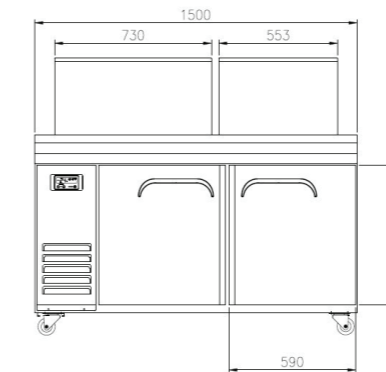

FTT-1500

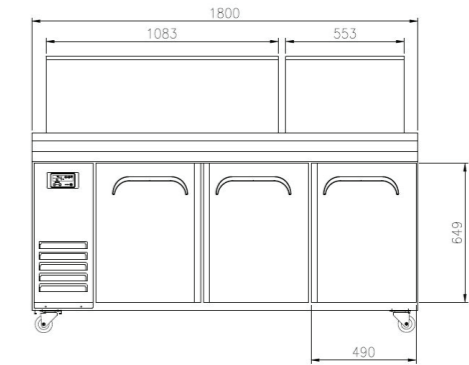

FTT-1800

*The heights include the castor (104mm)

FEATURES

- Auto-closing doors & stopper
- Magnetic door gasket
- Stainless steel hood lid covers
- Locking dividers
- 344mm reversible cutting board
- PVC coated sturdy wire shelves
- 3" casters (brakes at front)
- Accommodates 15cm deep pan (*pans are optional)
- Stainless steel finished top, front, sides and doors
- Stainless hoodlid cover

TEMPERATURE

- 0°C ~ 5°C

OPTIONAL MODEL

- Leg model available

Model	Capacity (ℓ)	Exterior Dimension (mm)			Net Weight (kg)	Gross Weight (kg)	Power Supply	Amps	Watt	HP	Refrigerant	No. Door	No. Pans (1/3")
		W	D	H									
FTT-900	200	900	750	974	75	86	10A	2.0	340	1/3	R-134a	1	4
FTT-1200	300	1,200	750	974	90	103	10A	2.0	340	1/3	R-134a	2	6
FTT-1500	412	1,500	750	974	100	115	10A	2.0	340	1/3	R-134a	2	7
FTT-1800	512	1,800	750	974	115	132	10A	2.0	340	1/3	R-134a	3	9